



All-day comfort and wind-noise reduction

Sitting closely and lightly behind your ear, the Jabra WAVE - CORDED headset prevents wind and back-ground noise from interfering with your conversations. And with its carefully placed mic, the sound quality is always crystal clear. When you wear the Jabra WAVE - CORDED, you hear every word.

The Jabra WAVE - CORDED is slim and exceptionally comfortable. A new more advanced version of the classic behind-the-ear style, it can be worn with ease all day long. The Jabra WAVE - CORDED makes sure you never miss an opportunity. Wear it to work, on the move or in the car.



Reasons to choose the Jabra WAVE - CORDED

- Behind-the-ear style for all day comfort
- Wind noise reduction for clear conversations
- Adapter for mobile phone compatibility



* Compatible with most phones with 3.5mm plug (Apple iPhone[®], HTC, Blackberry, LG, Motorola). Use extra phone adapter in pack for compatibility with most phones from Nokia, Sony Ericsson and Samsung.

A BRAND BY

GN Netcom

JABRA[®] IS A REGISTERED TRADEMARK OF GN NETCOM A/S

WWW.JABRA.COM/WAVECORDED



Quick Start Guide

Connect to your mobile or Smartphone

Connect your Jabra WAVE - CORDED headset to your mobile phone, simply by plugging the cord into your phone. Jabra WAVE - CORDED includes adapters for compatibility with most mobile and Smartphones on the market.

Using your headset

Answer a call - Tap the answer/end button on your headset.
End a call - Tap the answer/end button to end an active call.
For extra windy situations Jabra supplies a wind sock that even further improves the wind noise reduction.

Wearing style

With the Jabra WAVE behind-the-ear wearing style allows you to wear the headset on both ears simply by twisting the eargel to fit left or right ear. The eargel comes in two sizes to ensure a good fit for all.

Features and Specifications

1. Behind the ear wearing style offers great comfort and discreet look
2. 3 layer wind noise protection ensures quality sound on the go
3. Wear it with your preferred eargel size. Two sizes are provided for individual comfort
4. L 100 x H 45 x T 12 mm (L 3.9 x H 1.8 x T 0.5 in)
5. Features on-cord answer/end button*

* Phone dependent

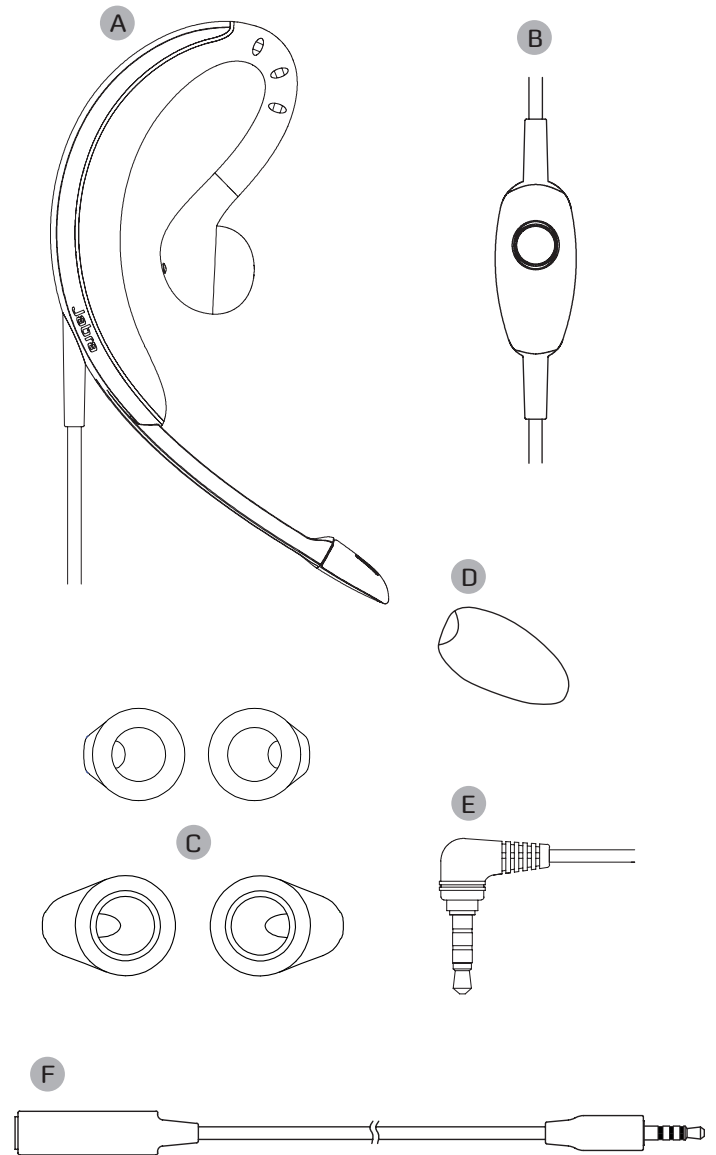

A Mono corded headset with microphone in boom tip

B Control box

C Four Ultimate Comfort Eargels for optimal fit

D Wind Sock
(for wind noise protection)

E 3.5mm plug
(works with most mobile phones from Apple iPhone®, HTC, LG, Blackberry or Motorola)

F Extra adapters for compatibility with 2.5mm phones or other 3.5mm phones
(works with most phones from Nokia, Sony Ericsson and Samsung)

A BRAND BY



JABRA® IS A REGISTERED TRADEMARK OF GN NETCOM A/S

WWW.JABRA.COM/WAVECORDED